

ADUOSMART ERIA[®]

USER MANUAL WIRELESS CONTACT SENSOR

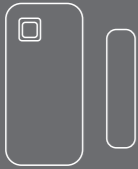

1. Place the battery in the battery compartment.

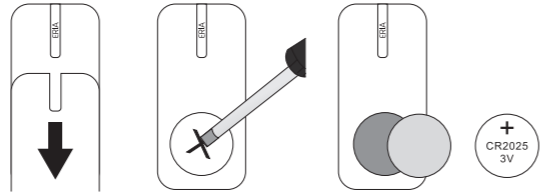

Connect with the ERIA hub

2A. Download the Aduosmart App from the Apple App Store or from Google Play or go to <http://aduosmart.com/aduosmart-app/>



2B. If you have a **third party ZigBee compatible hub** then **proceed to step 9.**

3. Open the Aduosmart ERIA App.



4. On the bottom right corner press on "Settings".

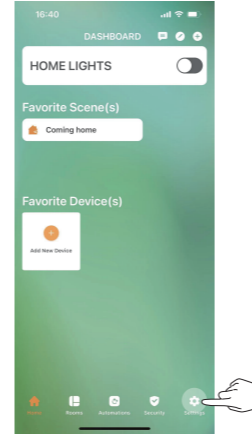

5. Select "Devices".

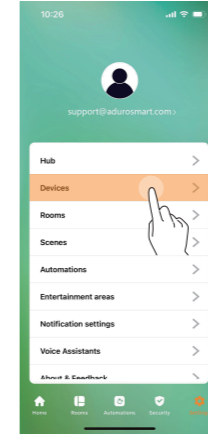

6. On the top right corner press on the "+" symbol then press on "Add device".

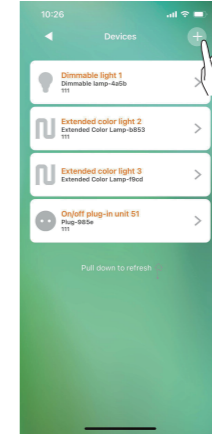

7. Press on "Brands" and then select "Aduosmart ERIA".

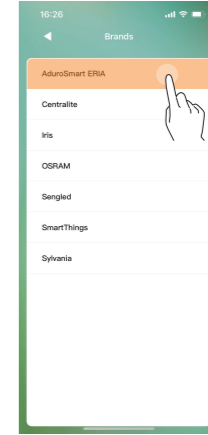

8. Press on "Contact Sensor".

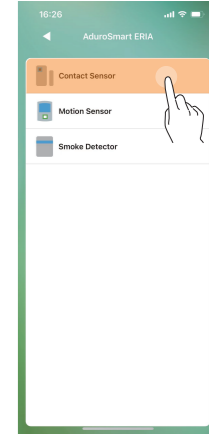

9. Locate the small pinhole button on the side of the sensor use a small pin or paperclip to press the button for 2 seconds. The LED indicator will flash continuously for 60 seconds indicating that the sensor is in pairing mode.

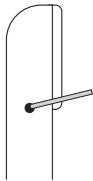

10. Proceed by pressing on "Search" to allow the Aduosmart ERIA hub to find the sensor, the LED indicator on the hub will **flash green** this indicates that the hub is searching for new devices.

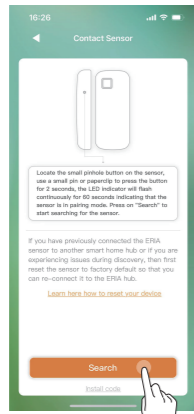

9B. If you have a **third party hub**, then this is the moment to **initiate the search from your Smart Home hub app.**

11. When the sensor has been found and paired successfully the sensor will stop flashing and it will show up in your search results, press on "Done" to complete the process.

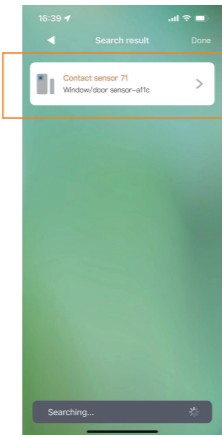

12. Troubleshoot

If you are experiencing issues while connecting the Sensor then please follow below instructions to reset the sensor.

Locate the small pinhole button on the sensor, use a small pin or paperclip to press the button for 10 seconds the sensor LED indicator will flash quickly to confirm the reset.

LED FUNCTION TABLE

Connection mode	LED will flash once per second for approximately 1 min.
Connection successfully	LED will stop flash.
Sensor reset	LED will flash quickly.
Sensor triggered When sensor is triggered in case of opening or closing the doors or windows.	LED will flash once.

NEED HELP? CALL US

For troubleshoots, instruction video's or more information please visit us at www.aduosmart.com/faq

Chat with one of our support agents at www.aduosmart.com

The Netherlands: +31 523687532
support@aduosmart.eu



www.aduosmart.com/manuals/contactsensor